



# 8,000 lb. Spring Axles

Typical Industries & Applications include:

- Recreational Vehicle Trailers
- Enclosed Trailers
  - Cargo
  - Vehicle
  - Race Vehicle
- Open Utility Trailers
  - Landscape
  - Equipment
  - Dump Trailers
  - Construction
- Agricultural Equipment
  - Feed & Grain
  - Spreaders
  - Transport
- Marine Trailers



### Mounting and Dimensions

In order to minimize tire wear and axle performance issues Axis recommends that the following guidelines be followed when specifying axles within the 8,000 lb. The difference between hub face and spring center based on spindle and brake flange.

Type	Flange	Minimum	Maximum
Straight Spindle	Flanged	16.00"	19.00"

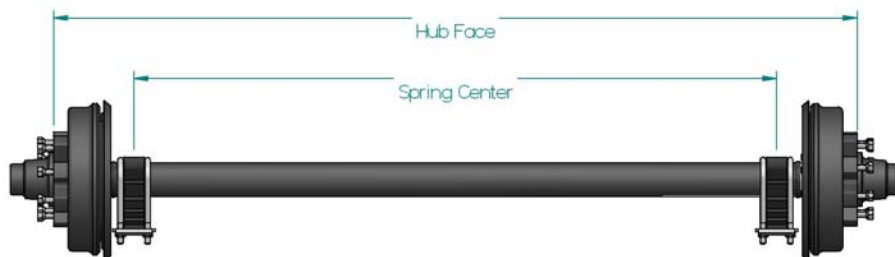

### OPTIONS:



Standard Camber

Available Finishes include:

- Powder Coating
- Galvanized
- Wet Paint

8,000 SA



# 8,000 lb. Spring Axles

## SLIPPER SPRING AXLE CONFIGURATIONS

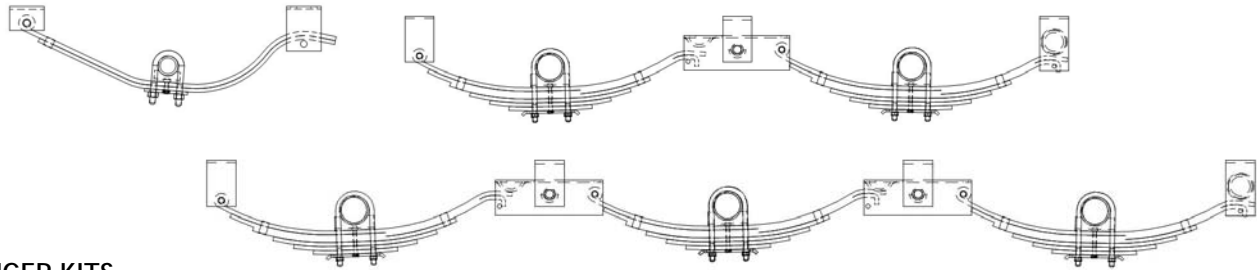

### HANGER KITS

CONFIGURATION	AXIS P/N	AXLE SPACING (TYPICAL)	DESCRIPTION (CONTENTS)
SINGLE KITS		33-1/2" Spacing, 24" Hanger	4 pcs. 1584-4 Hanger, 6 pcs. 3-1/2" Shackle Bolt, 6 pcs. Lock Nut
		33-1/2" Spacing, 24" Hanger	2 pcs. 1584-4 Front Hanger, 2 pcs. 1585-4 Rear Hanger, 4 pcs. 3-1/2" Shackle Bolt, 4 pcs. Lock Nut
TANDEM KITS		33-1/2" Spacing, 28 7/8" Hanger	2 pcs. 1584-4 Front Hanger, 2 pcs. 1585-4 Rear Hanger, 2 pcs. 1586-4 Center Hanger, 2 pcs. 5541 Equalizer, 2 pcs. 7-1 Equalizer Bolt, 2 pcs. 6-3 Nut, 4 pcs. 7-7 Keeper Bolt, 4 pcs. 6-11 Keeper Nut, 4 pcs. 3-1/2" Shackle Bolt, 4 pcs. Lock Nut
TRIPLE KITS		33-1/2" Spacing, Front/Rear 28-7/8" Center 33"	4 pcs. 1584-4 Front Hanger, 2 pcs. 1585-4 Rear Hanger, 2 pcs. 1586-4 Center Hanger, 4 pcs. 5541 Equalizer, 4 pcs. 7-1 Equalizer Bolt, 4 pcs. 6-3 Nut, 6 pcs. 7-7 Keeper Bolt, 6 pcs. 6-11 Keeper Nut, 6 pcs. 3-1/2" Shackle Bolt, 6 pcs. Lock Nut

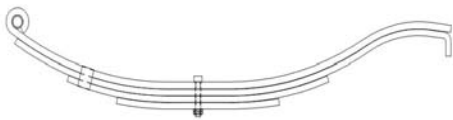

### SLIPPER SPRINGS

AXIS P/N	CAPACITY	LENGTH	Description
780300051150	4000 lb.	29-1/8"	E5115 Slipper Spring 6 Leaf, 2" Wide

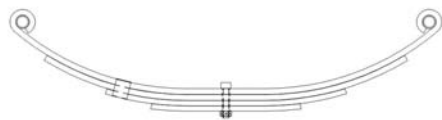

### DOUBLE EYE SPRINGS

AXIS P/N	CAPACITY	LENGTH	Description
780312680000	4000 lb.	26"	AWS 8 8 Leaf Spring, 2" Wide

↪ Contact Axis Product Service and Sales Department to Order

**Quality Driven...**  
**Customer Focused**





# 8,000 lb. Spring Axles

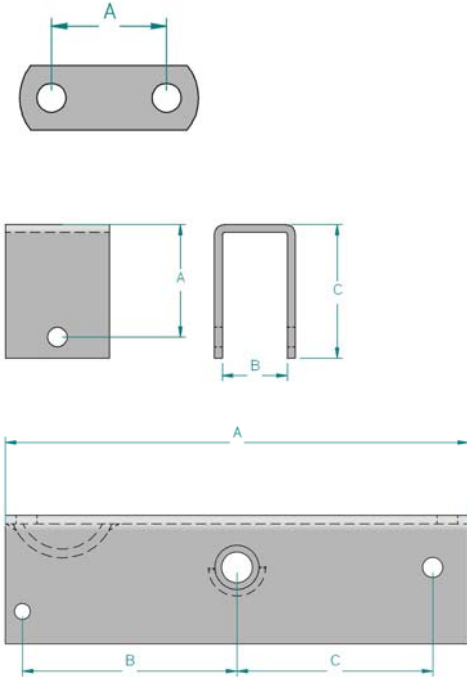

## SUSPENSION HARDWARE

AXIS P/N	Description	A	B	C	Double Eye/ Slipper
78671909181	Shackle Bolt Lock Nut				DE/Slipper
77071135180	7-7 Keeper Bolt				Slipper
750721305180	6-11 Keeper Bolt				Slipper
770362135541	5541 HD Equalizer	12"	4.44"	4.75"	Slipper
770711214090	7-1 Equalizer Bolt				Slipper
770722124090	6-3 Equalizer Bolt Nut				Slipper
770815158440	1584-4 Front Hanger	3.56"	2.19"	4.31"	Slipper
770815158640	1586-4 Equalizer Hanger	3.375"	3.125"	4.125"	Slipper
770815158540	1585-4 Rear Hanger	5.06"	2.19"	6.00"	Slipper
786711909182	3-1/2" Shackle Bolt				Slipper

## U-Bolts & Tie Plates

AXIS P/N	Description
788711108200	U-Bolt X-Long 7-3/4" 11-65
787814123500	Large Tie Plate 12-37
788711108199	Nut for 11-65 U-Bolt

## BRAKES

AXIS P/N	Description
770512501000	12-1/4" x 3 3/8" Left Hand Electric Brake, Self Adjusting
770512502000	12-1/4" x 3 3/8" Right Hand Electric Brake, Self Adjusting

## HUBS (All Parts (w/AP) Includes—Bearings, Seal, Dust Cap, Wheel Nuts & Grease)

AXIS P/N w/AP	AXIS P/N Race Only	Bolt Pattern	Description
	770412158650	8 on 6.5"	8K Hub Drum, 5/8" Studs, 4.75" Pilot Diameter
	770412908654	8 on 6.5"	8K Hub Rotor Integral, Standard Automotive Finish

Contact Axis Product Service and Sales Department to Order

Quality Driven...  
Customer Focused





# 8,000 lb. Spring Axles

## HUB HARDWARE

AXIS P/N	Description
785452213900	Grease Cap for Standard Spindle 865 21-39
786722016140	1-14 Slotted Jam Nut, 6 Slots
786930200000	"O" Washer, 1.67" O.D. / 1" I.D.
786940000000	1/8" x 1-3/4" Cotter Pin
766252010036	Grease Seal for 8K Hub Drum
764254255800	25580 Inner Tapered Roller Bearing
764254024750	02475 Outer Tapered Roller Bearing
764254141250	14125A Outer Tapered Roller Bearing for Disc Brake
750730008150	5/8" Cone Wheel Nut
770963150000	21-43-01 865 Zinc Grease Cap for SAF-T-LUB
786930000000	"D" Washer for SAF-T-LUB
770963120000	5-101 Tang Washer for SAF-T-LUB
799994300000	8K Oil Bath Cap
796714406552	8K Caliper for Disc Brake
787814004000	8K Mounting Bracket for Disc Brake

## WHEEL & TIRE ASSEMBLIES

AXIS P/N	DESCRIPTION	WHEEL DIA.	TYPE	LOAD RANGE	SLR	PSI	MAX LOAD CAP. (LBS)

↳ Contact Axis Product Service and Sales Department to Order



**Quality Driven...  
Customer Focused**